

CE

Edition

10/2010



**MAINTENANCE AND OPERATING MANUAL**  
**TIMER CONTROLLED CONDENSATE DRAIN**  
***type TD16s***



Dear Customer,

thank you for choosing our product. In order to get the best performances in the use of this product, please read carefully this manual. To avoid incorrect operations of the equipment and possible physical risks to the operator, please read and strictly follow the instructions contained in this manual. Note, these instructions are in addition to the safety rules that apply in the country where the product is installed. This manual must be maintained available in any moment for future references and it has to be intended as inherent part of the product.

Due to the continuous technical evolution, we reserve the right to introduce any necessary change without giving previous notice.

In the case of any troubles, or for further information, please do not hesitate to contact us.

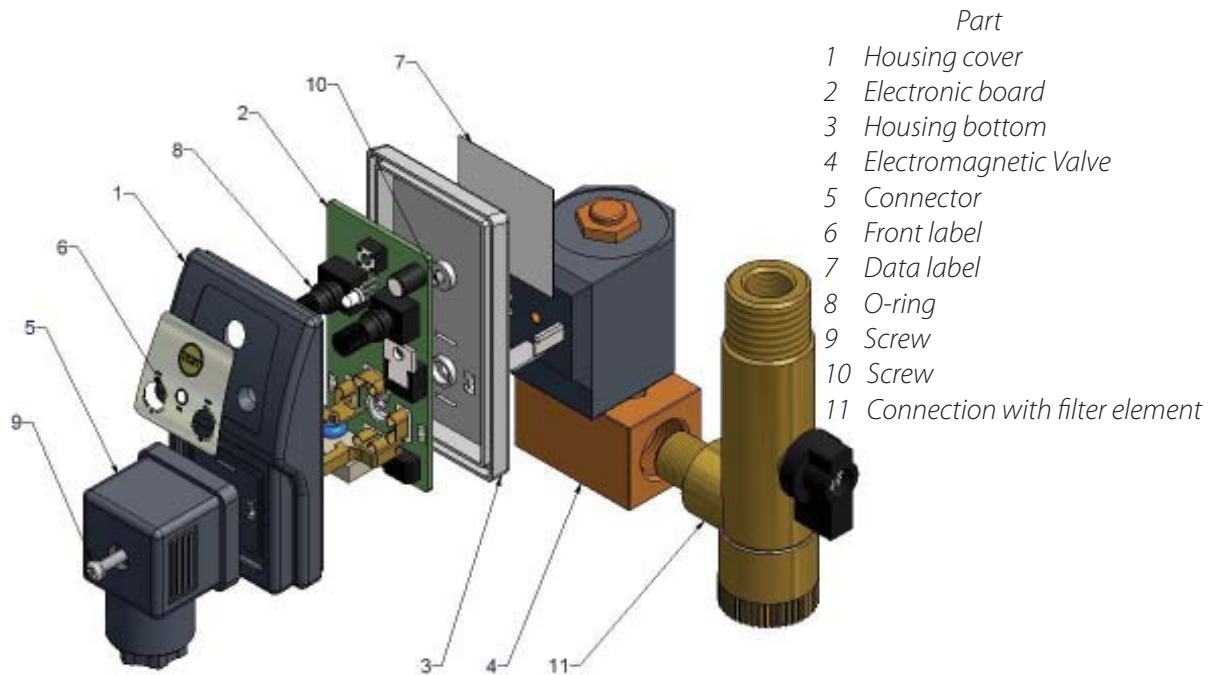

Part

- 1 Housing cover
- 2 Electronic board
- 3 Housing bottom
- 4 Electromagnetic Valve
- 5 Connector
- 6 Front label
- 7 Data label
- 8 O-ring
- 9 Screw
- 10 Screw
- 11 Connection with filter element

Overall length	L= 90,5 mm
Overall height	H=123 mm
Overall width	B= 87,5 mm
Overall weight	m= 350g
Max. discharge capacity:	95 l/h
Inlet connection dimension	½"
Outlet connection dimension	¼"
Max. working pressure P <sub>max</sub> =	16 bar (232 psi)
Operation temperature range	T= +1,5 to +65 °C (35 to 149 °F)
Working medium	Condensate water, compressed air
Voltage	230 Vac; ±10%, 50/60Hz
Current	
Housing protection	IP65

## INSTALLATION

1. Install TD16S on compressed air filter or pressure vessel observing vertical orientation and lowest point (fig.1,2).
2. Connect device on electrical network .
3. Slowly open inlet valve and re-pressurise system.
4. Push the Test button to see if device is working properly (fig. 5).
5. Adjust two buttons in order to achieve optimum discharge parameters. With left button adjust discharge time, with right button adjust time between discharging.

It is recommended to put ball valve and connection nipple between TD16 and filter, vessel...

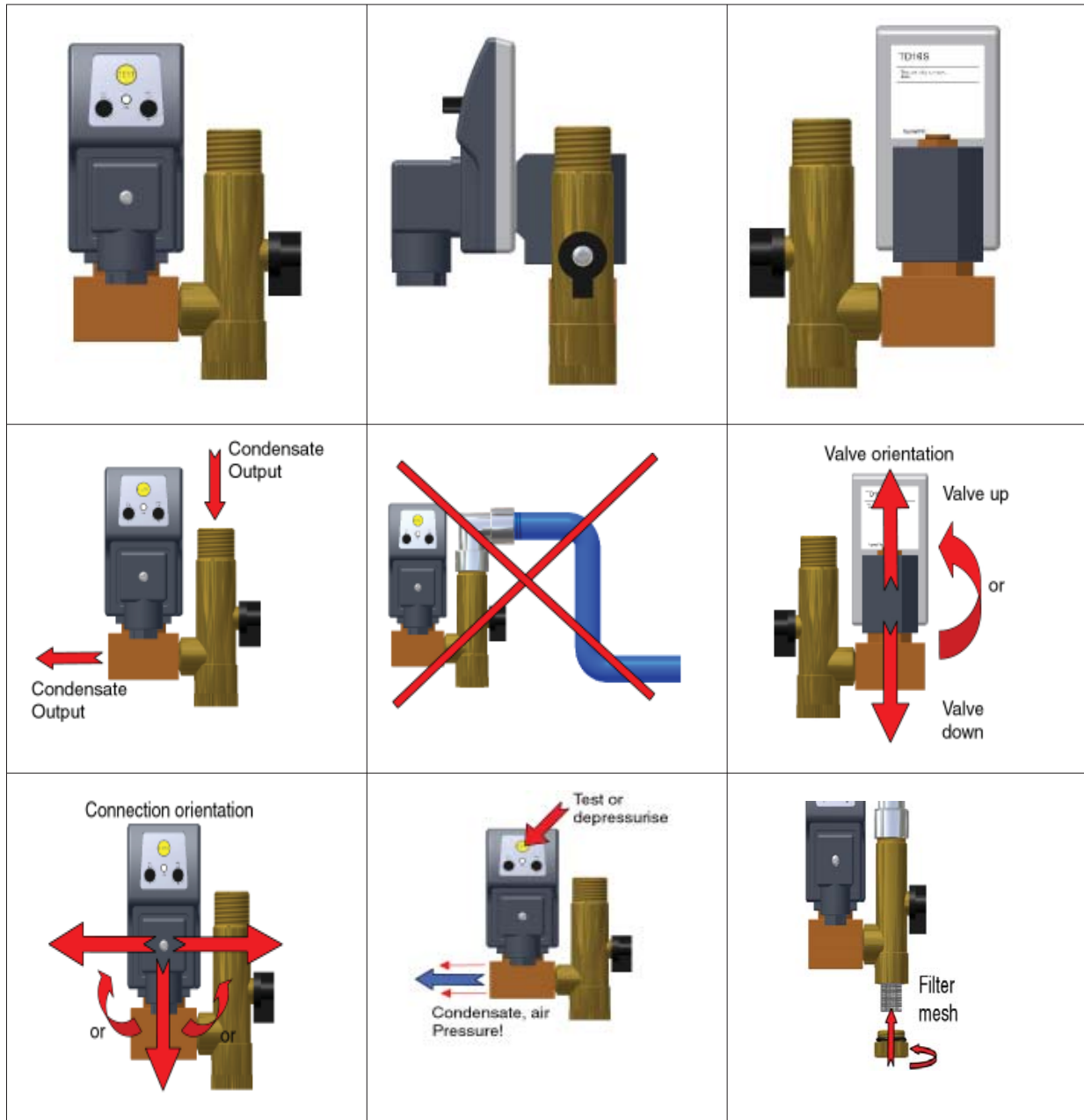

## DESCRIPTION AND OPERATING PRINCIPLE

### DESCRIPTION

Timer controlled drain TD16S automatically discharges condense from compressed air filters, vessels,... Its timer controlled electronics provides very safe and durable operation.

### WORKING PRINCIPLE

TD16S is timer controlled automatic drain. When the time set parameter is achieved electromagnetic valve opens and discharge begins. Discharging and waiting interval can be set by turning two buttons (left=time of discharging, right=time of waiting). Intervals are continuously repeating.

TD16S has control panel with two buttons for adjusting time parameters, test button for manual discharge and led light (red/green) for status power (green) and status discharge (red).

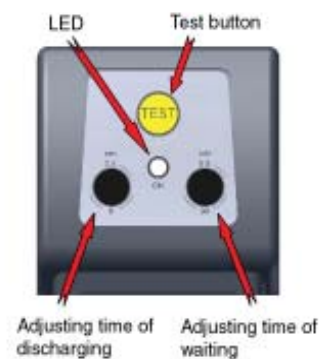

## CONNECTION

Connection can be executed only by qualified person. All safety requirements must be carried out. Before connecting check up, that equipment does not have any visual injuries or defects. Pay attention to appropriate voltage!! Ground connections must be performed.

### ATTENTION!

Before service works and before any maintenance works, disconnect device from power supply. Never proceed service and maintenance works, if device is still under pressure.

## MAINTENANCE AND SERVICE

### WARNING!

Before service and maintenance disconnect device from electrical supply, and shut off compressed air supply to a TD16S.

- Occasionally push the test button on the device to check faultless discharge. Proceed testing until all condense is discharged from device.
- When assembling the device, be careful that all seals are on position and there are no damage on them. If seals are damaged replace them with original components.
- Use only original spare parts.
- Do not operate above maximum working pressure and max. Temperature.
- Do not remove repair or replace any item on TD16S whilst it is under pressure.

Note: Standard TD16S condense drain must not be used on High pressure filters.



**MIAS i Ängelholm AB**  
Helsingborgsvägen 33A  
262 72 Ängelholm  
Sweden

Phone: +46 (0) 431- 31 19 31  
Phone: +46 (0) 431-41 23 40  
Fax: +46 (0) 431-802 25  
E-mail: [christer.miasab@telia.com](mailto:christer.miasab@telia.com)  
web site: [www.miasab.se](http://www.miasab.se)